

MODEL 1120

THERMOELECTRIC GENERATOR (HAZARDOUS AREA GENERATOR)

Global's Model 1120 Thermoelectric Generator is Class 1, Div. 2 or Class 1, Div. 1 Hazardous area rated. With no moving parts it is a reliable, low maintenance source of DC electrical power for any application where regular utilities are unavailable or unreliable.

POWER SPECIFICATIONS

Power Ratings @ 20°C	110 Watts @ 6.7 Volts
	100 Watts @ 12 Volts
	100 Watts @ 24 Volts
	100 Watts @ 48 Volts

ELECTRICAL

Adjustment	6.7 V up to 11 Volts
	12 V 12 - 18 Volts
	24 V 24 - 30 Volts
	48 V 48 - 60 Volts
Reverse Current Protection	Yes
Output	Terminal block which accepts up to 00 AWG wire. Opening for 2, 3/4" NPT ports in the base of the electronics enclosure.

FUEL

Natural Gas	8.8 m ³ /day (311 ft ³ /day) of Std. 1000 BTU/SCF (37.7 MJ/Sm ³) gas
Propane	11.4 l/day (3.0 US gal/day)
Maximum Supply Pressure	1724 kPa (250 psi)
Minimum Supply Pressure	103 kPa (15 psi)
Fuel Connection	1/4" MNPT

ENVIRONMENTAL

Ambient Operation Temperature	Max. 55°C (130°F) Min. -55°C (-67°F)
Operating Conditions	Unsheltered Operation Certified for use in Hazardous Areas

MATERIALS OF CONSTRUCTION

Cabinet	316 SS
Cooling Type	Natural Convection
Thermopile	Hermetically Sealed Lead Tin-Telluride (PbSnTe)
Burner	Meeker Type/Inconel 600
Fuel System	Brass, Aluminum & SS

Model 1120



STANDARD FEATURES

- Automatic Spark Ignition (SI)
- Fuel Filter
- Automatic Fuel Shut-off (SO)
- Low Voltage Alarm Contacts (VSR)
- Volt & Amp Meters
- Flame Arrestor
- Corrosive Environment Fuel System
- CSA Certification (Class 1, Div.2, Group D, Temp T3)

OPTIONAL FEATURES

- FM Certification (Class1,Div.1, Temp T3)
- Corrosion resistant Upgrade (Div. 2 Version)
 - 316 SS regulator & fuel valve
 - Corrosion resistant alloy coated combustion chamber
- Cathodic Protection Interface Panel
- Pole Mount or Bench Stand

NOTE: Specifications shown are for standard configurations. Global thermoelectric's Applications Engineering Department is available to design installations meeting different specifications, including custom voltages, fuel supply systems and non-standard operating temperatures.



ISO 9001:2000 Registered

Corporate Office

#9, 3700 - 78 Avenue SE
Calgary, Alberta T2C 2L8
CANADA
Phone: (403) 236-5556
Fax: (403) 236-5575
E-mail: tegsales@globalte.com

US Sales

521 North Sam Houston Parkway E Suite 525
Houston, Texas USA 77060
Phone: (281) 445-1515
Fax: (281) 445-6060
Toll Free: 1 800 848-4113
E-mail: tegsales@globalte.com

Model 1120 Typical Installation

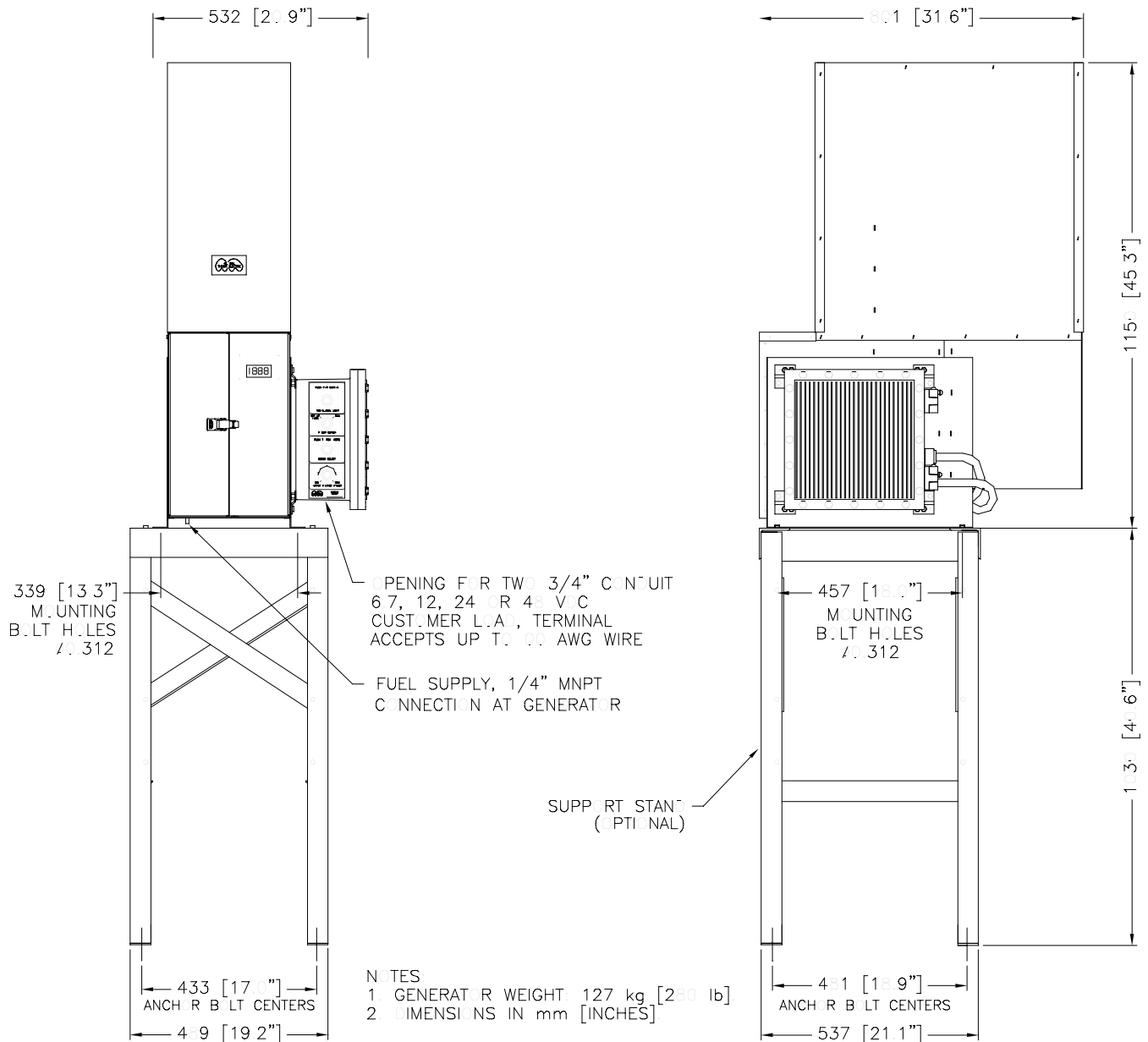

www.globalte.com

Corporate Office

#9, 3700 - 78 Avenue SE
Calgary, Alberta T2C 2L8
CANADA
Phone: (403) 236-5556
Fax: (403) 236-5575
E-mail: tegsales@globalte.com

US Sales

521 North Sam Houston Parkway E Suite 525
Houston, Texas USA 77060
Phone: (281) 445-1515
Fax: (281) 445-6060
Toll Free: 1 800 848-4113
E-mail: tegsales@globalte.com